



# F2TVS10.0A thru F2TVS190A

Surface Mount Transient Voltage Suppressors  
Peak Pulse Power 200W Stand-off Voltage 10.0 to 190V

## Features

- Glass passivated junction
- Moisture sensitivity: level 1, per J-STD-020
- Solder dip 260 °C, 10 s
- Low profile, typical thickness 1.0mm
- Polarity: Uni-directional
- Excellent clamping capability and Fast response time
- 200W peak pulse power capability with a 10/1000us waveform

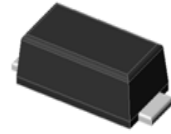

eSGA  
(SOD-123FL)

## Typical Applications

Use in sensitive electronics protection against voltage transients induced by inductive load switching and lighting on Ics, MOSFET, signal lines of sensor units for consumer, computer, industrial and telecommunication

Maximum Ratings (TA = 25 °C unless otherwise noted)			
Parameter	Symbol	Value	Unit
Peak power dissipation with a 10/1000us waveform	$P_{PPM}^{1)}$	Minimum 200	W
Peak pulse current with a 10/1000us waveform	$I_{PPM}^{1)}$	See Next Table	A
Steady state power dissipation on infinite heatsink	$P_{M(AV)}^{2)}$	0.5	W
Peak forward surge current, 8.3ms single half sine-wave uni-directional only	$I_{FSM}$	30.0	A
Maximum instantaneous forward voltage at 25A	$V_F$	3.5	V
Operating junction and storage temperature range	TJ, TSTG	-65 to +150	°C
Typical thermal resistance	$R_{\theta JA}$	85	°C/W
	$R_{\theta JC}$		
	$R_{\theta JL}$		

Notes:

1) Non-repetitive current, per fig.3 and derated above TA=25°C per fig.4.

2) Power dissipation mounted on recommended pad layout

3) Thermal resistance from junction to ambient, mounted on PCB with 5.0x5.0mm copper pads



# F2TVS10.0A thru F2TVS190A

Surface Mount Transient Voltage Suppressors  
Peak Pulse Power 200W Stand-off Voltage 10.0 to 190V

## Electrical Characteristics (TA = 25 °C unless otherwise noted)

Part Number	Marking Code	Reverse Stand-off Voltage	Breakdown Voltage		Test Current	Max Reverse Leakage Current	Max. Clamp Voltage	Peak Pulse Current
		VRWM	VBR @ IT		IT	IR @ VRWM	Vc @ IPP	IPP
			Min	Max				
		V	V	V				
F2TVS10A	10A	10	11.1	12.3	1	5	17	11.8
F2TVS11A	11A	11	12.2	13.5	1	5	18.2	11
F2TVS12A	12A	12	13.3	14.7	1	5	19.9	10.1
F2TVS13A	13A	13	14.4	15.9	1	5	21.5	9.3
F2TVS14A	14A	14	15.6	17.2	1	5	23.2	8.62
F2TVS15A	15A	15	16.7	18.5	1	5	24.4	8.2
F2TVS16A	16A	16	17.8	19.7	1	5	26	7.69
F2TVS17A	17A	17	18.9	20.9	1	5	27.6	7.25
F2TVS18A	18A	18	20	22.1	1	5	29.2	6.85
F2TVS20A	20A	20	22.2	24.5	1	5	32.4	6.17
F2TVS22A	22A	22	24.4	26.9	1	5	35.5	5.63
F2TVS24A	24A	24	26.7	29.5	1	5	38.9	5.14
F2TVS26A	26A	26	28.9	31.9	1	5	42.1	4.75
F2TVS28A	28A	28	31.1	34.4	1	5	45.4	4.41
F2TVS30A	30A	30	33.3	36.8	1	5	48.4	4.13
F2TVS33A	33A	33	36.7	40.6	1	5	53.3	3.75
F2TVS36A	36A	36	40	44.2	1	5	58.1	3.44
F2TVS40A	40A	40	44.4	49.1	1	5	64.5	3.1
F2TVS43A	43A	43	47.8	52.8	1	5	69.4	2.88
F2TVS45A	45A	45	50	55.3	1	5	72.7	2.75
F2TVS48A	48A	48	53.3	58.9	1	5	77.4	2.58
F2TVS51A	51A	51	56.7	62.7	1	5	82.4	2.43
F2TVS54A	54A	54	60	66.3	1	5	87.1	2.3
F2TVS58A	58A	58	64.4	71.2	1	5	93.6	2.14
F2TVS60A	60A	60	66.7	73.7	1	5	96.8	2.07
F2TVS64A	64A	64	71.1	78.6	1	5	103	1.94
F2TVS70A	70A	70	77.8	86	1	5	113	1.77
F2TVS75A	75A	75	83.3	92.1	1	5	121	1.65
F2TVS78A	78A	78	86.7	95.8	1	5	126	1.59
F2TVS80A	80A	80	88.8	97.6	1	5	129	1.55
F2TVS85A	85A	85	94.4	104	1	5	137	1.46
F2TVS90A	90A	90	100	111	1	5	146	1.37
F2TVS100A	100A	100	111	123	1	5	162	1.23
F2TVS110A	110A	110	122	135	1	5	177	1.13
F2TVS120A	120A	120	133	147	1	5	193	1.04
F2TVS130A	130A	130	144	159	1	5	209	0.96
F2TVS140A	140A	140	155	171	1	5	224	0.89
F2TVS150A	150A	150	167	185	1	5	243	0.82
F2TVS160A	160A	160	178	197	1	5	259	0.77
F2TVS170A	170A	170	189	209	1	5	275	0.73
F2TVS180A	180A	180	201	222	1	5	292	0.69
F2TVS190A	190A	190	211	232	1	5	324	0.62



# F2TVS10.0A thru F2TVS190A

Surface Mount Transient Voltage Suppressors  
 Peak Pulse Power 200W Stand-off Voltage 10.0 to 190V

## Ratings and Characteristics Curves

(TA = 25°C unless otherwise noted)

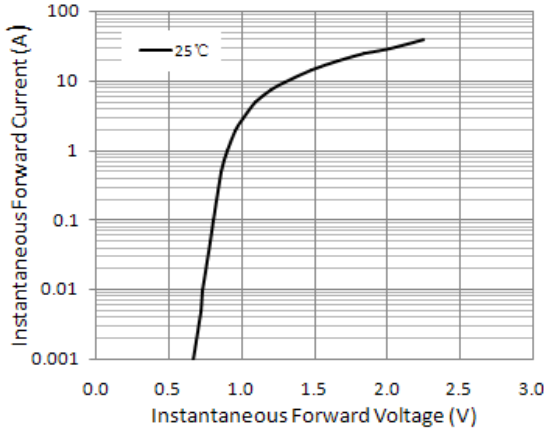

Figure 1. Typical Instantaneous Forward Characteristics

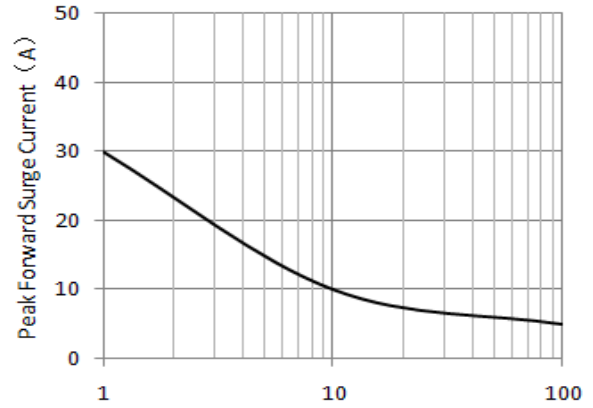

Figure 2. Maximum Non-Repetitive Peak Forward Surge Current

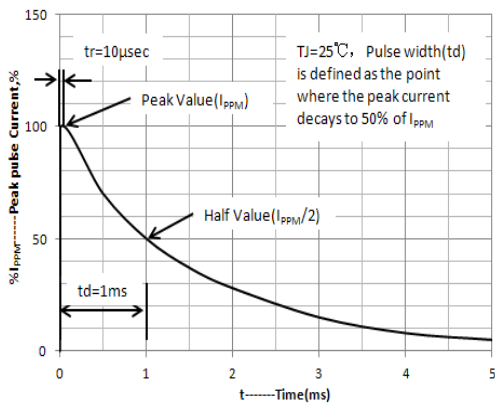

Figure 3. Pulse Waveform

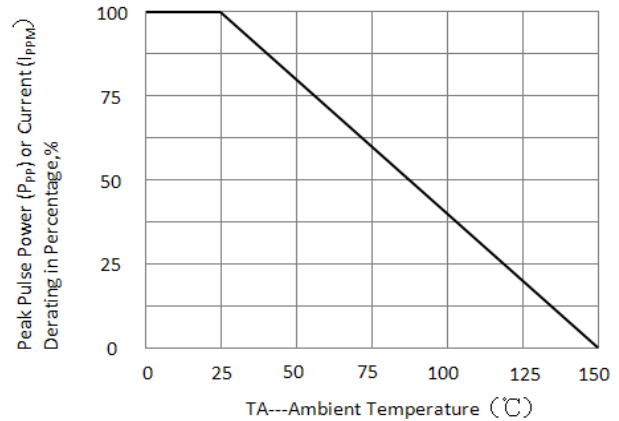

Figure 4. Peak Pulse Power Derating Curve

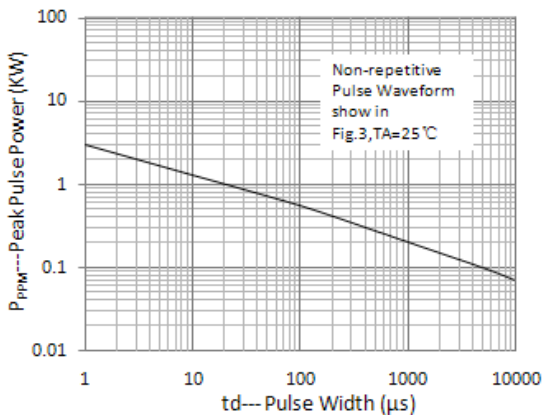

Figure 5. Peak Pulse Power Derating Curve



# F2TVS10.0A thru F2TVS190A

Surface Mount Transient Voltage Suppressors  
 Peak Pulse Power 200W Stand-off Voltage 10.0 to 190V

## Package Outline Dimensions

in inches (millimeters)

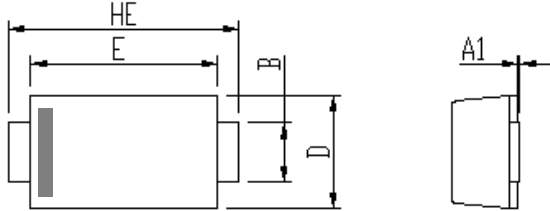

DM	Unit: mm		Unit: inch	
	M N	M A X	M N	M A X
A	0.9	1.08	0.035	0.043
A1	0	0.1	0.000	0.004
B	0.85	1.05	0.033	0.041
C	0.1	0.25	0.004	0.010
D	1.7	2	0.067	0.079
E	2.9	3.1	0.114	0.122
L	0.43	0.83	0.017	0.033
HE	3.5	3.9	0.138	0.154

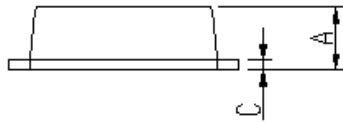

Soldering footprint

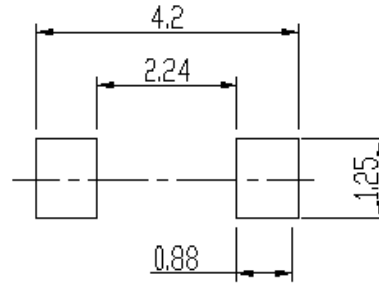
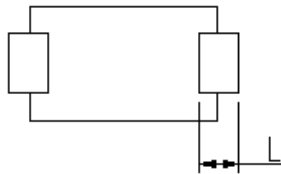

## Packing Information

**Packing quantities:**

3000 pcs/Reel, 40 Reels/Box; 8mm Tape, 7" Reel

**Tape & Reel Specification**

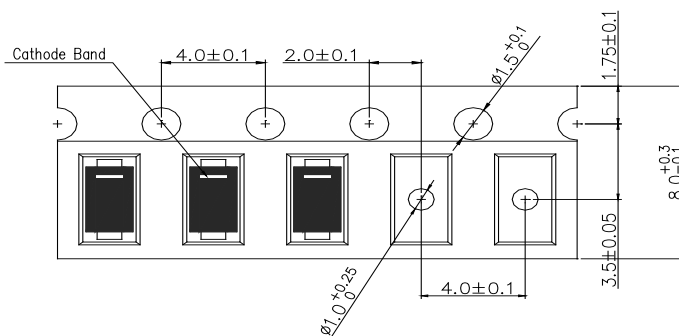

Version	Revision content	Date
A	Initial version release	Jun-21



# **F2TVS10.0A thru F2TVS190A**

**Surface Mount Transient Voltage Suppressors**  
**Peak Pulse Power 200W Stand-off Voltage 10.0 to 190V**

## Disclaimers

These materials are intended as a reference to assist our customers in the selection of the Suzhou Good-Ark product best suited to the customer's application; they do not convey any license under any intellectual property rights, or any other rights, belonging to Suzhou Good-Ark Electronics Co., Ltd. or a third party.

Suzhou Good-Ark Electronics Co., Ltd. assumes no responsibility for any damage, or infringement of any third-party's rights, originating in the use of any product data, diagrams, charts, programs, algorithms, or circuit application examples contained in these materials.

All information contained in these materials, including product data, diagrams, charts, programs and algorithms represents information on products at the time of publication of these materials, and are subject to change by Suzhou Good-Ark Electronics Co., Ltd. without notice due to product improvements or other reasons. It is therefore recommended that customers contact Suzhou Good-Ark Electronics Co., Ltd. or an authorized Suzhou Good-Ark Electronics Co., Ltd. for the latest product information before purchasing a product listed herein. The information described here may contain technical inaccuracies or typographical errors. Suzhou Good-Ark Electronics Co., Ltd. assumes no responsibility for any damage, liability, or other loss rising from these inaccuracies or errors. Please also pay attention to information published by Suzhou Good-Ark Electronics Co., Ltd. by various means, including our website home page.

(<http://www.goodark.com>)

When using any or all of the information contained in these materials, including product data, diagrams, charts, programs, and algorithms, Please be sure to evaluate all information as a total system before making a final decision on the applicability of the information and products. Suzhou Good-Ark Electronics Co., Ltd. assumes no responsibility for any damage, liability or other loss resulting from the information contained herein.

The prior written approval of Suzhou Good-Ark Electronics Co., Ltd. is necessary to reprint or reproduce in whole or in part these materials.

Please contact Suzhou Good-Ark Electronics Co., Ltd. or an authorized distributor for further details on these materials or the products contained herein.